

**ULINE**

# CLOSED INDUSTRIAL STEEL SHELVING

1-800-295-5510  
uline.com

## TOOLS NEEDED



11mm Wrench

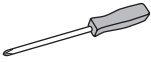

Phillips  
Screwdriver



Stepladder  
(optional)

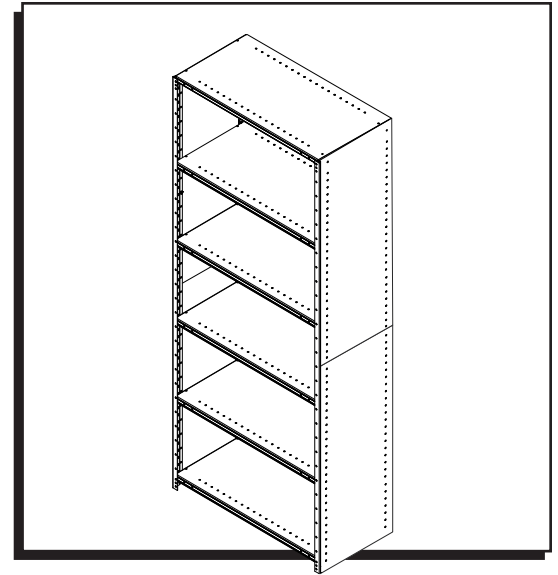

## PARTS

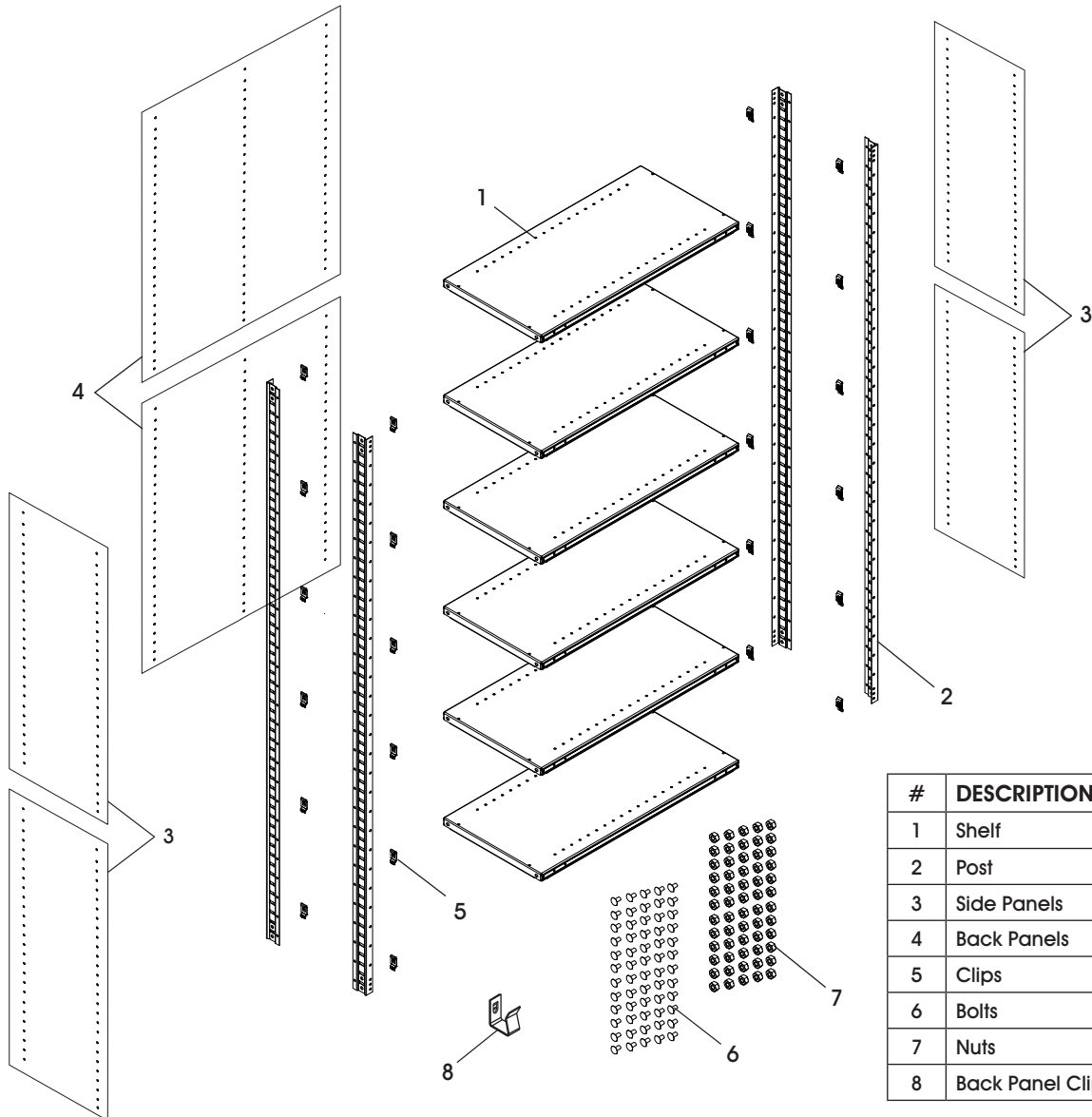

#	DESCRIPTION	QTY.
1	Shelf	6
2	Post	4
3	Side Panels	4
4	Back Panels	2
5	Clips	24
6	Bolts	60
7	Nuts	60
8	Back Panel Clip	1

# INSTRUCTIONS

Step 1

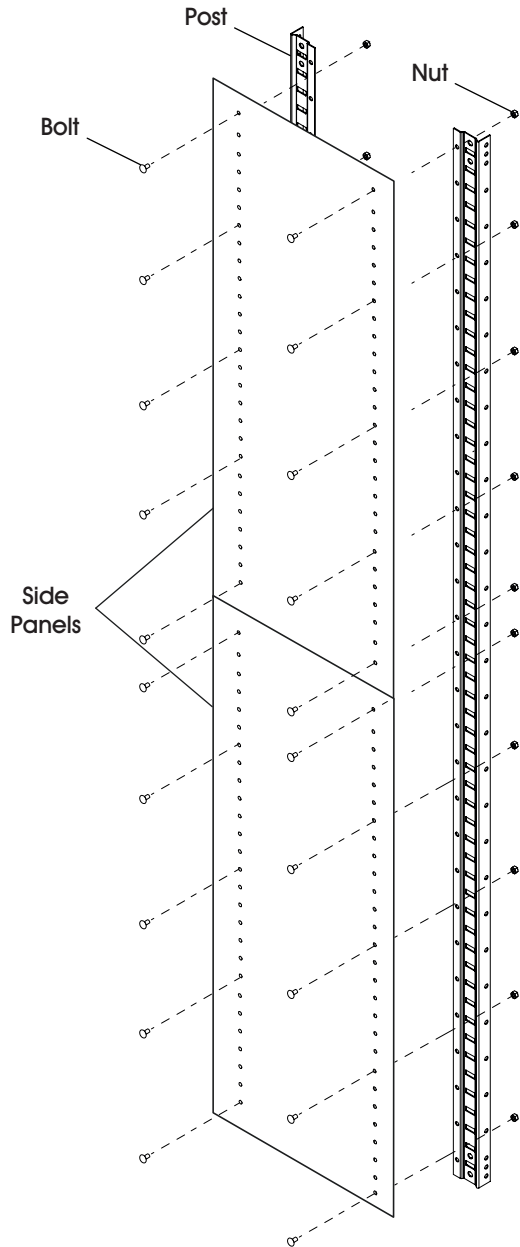

1. Align holes of side panels and posts and attach with nuts and bolts.

 **NOTE:** Use 10 nuts and bolts per post. Do not fully tighten nuts and bolts.

 **NOTE:** Side panels overlap. Be sure to align holes before attaching to posts.

Step 2

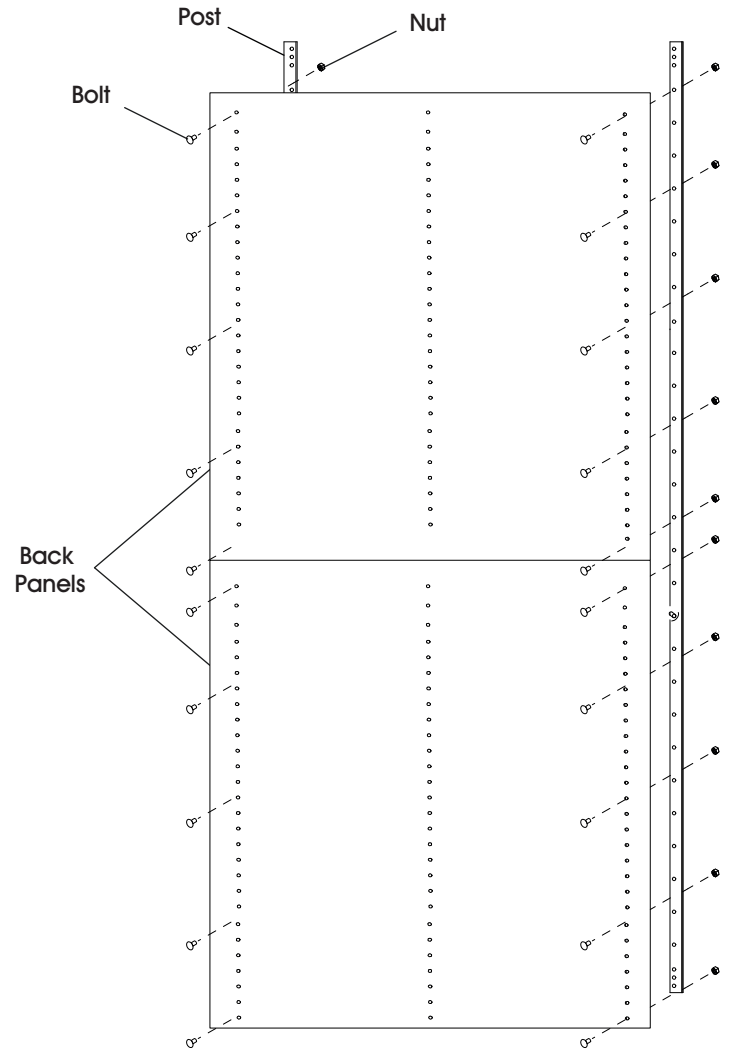

2. Align holes of back panels and posts and attach with nuts and bolts.

 **NOTE:** Use 10 nuts and bolts per post. Do not fully tighten nuts and bolts.

 **NOTE:** Back panels overlap. Be sure to align holes before attaching to posts.

# INSTRUCTIONS CONTINUED

Step 3

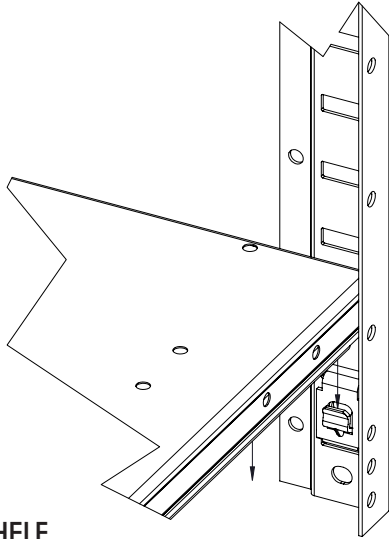

## BOTTOM SHELF

1. Insert clips into the bottom two slots of the posts.
2. Insert the shelf into the clips.

Step 4

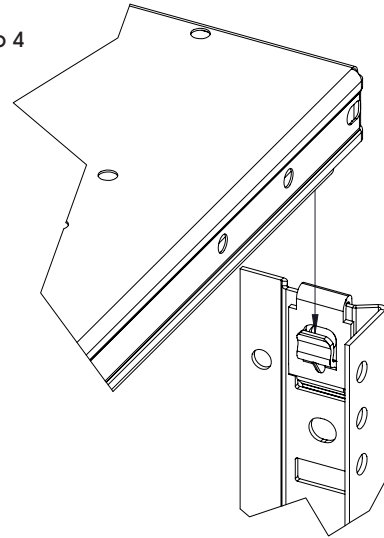

## TOP SHELF

1. Insert clips into the top and last slot of the posts.
2. Insert the shelf into the clips.

Step 5

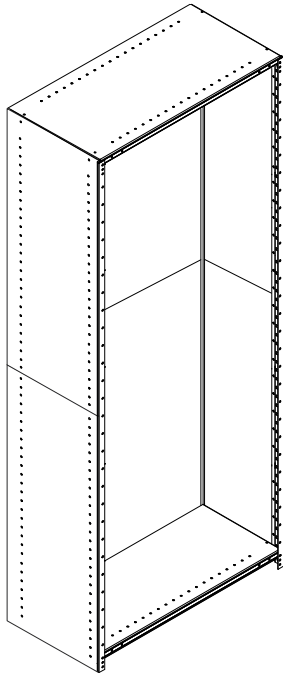

1. Make sure all nuts and bolts are fully tightened.

Step 6

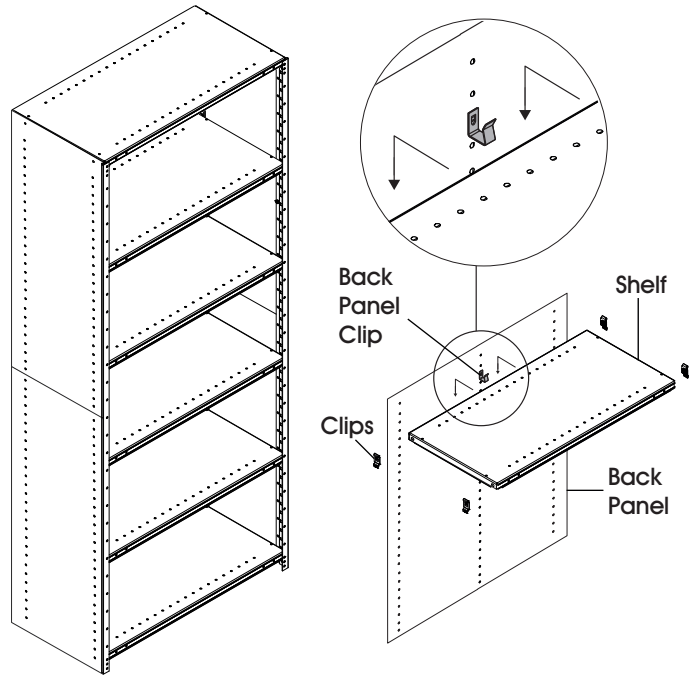

1. Insert remaining clips at desired shelf heights.
2. Insert remaining shelves into the clips.



**NOTE:** To keep the back panel pulled into the shelving unit, insert back panel clip into the center back panel holes where the shelf is to be located. Then insert shelf into the back panel clip and corresponding clips.